

Trunk Gender Changers

- Male-to-female
- Female-to-male, straight and 90° versions

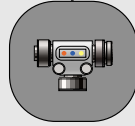

- Phosphor bronze contacts for greatest reliability
- Variety of male-to-female and female-to-male connection options for maximum installation flexibility

Gender changers are handy tools to change the connection interface from male to female or vice-versa. One version allows for the conversion of a female cordset to a male receptacle while another version allows for the conversion of a male cordset to a female receptacle. The right angle version is specifically designed for tight spaces where a tee connection will not fit such as bus IN/OUT connections on active modules or where a molded right angle connection on a molded cordset made to a specific length is not available for an immediate field need.



Gender Changers

TRUNK MALE

TRUNK FEMALE

FACE VIEWS

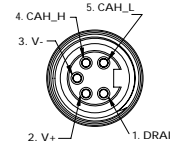
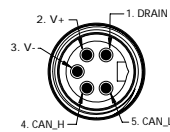

FIG	CHANGES FEMALE CORDSET TO MALE RECEPTACLE
1 AND 4	115060A
FIG	CHANGES MALE CORDSET TO FEMALE RECEPTACLE
2 AND 4	115010A
FIG	CHANGES RIGHT ANGLE MALE TO FEMALE CONNECTOR
3 AND 4	115032A

CATALOG OPTIONS

Use the following chart to modify your part's specifications

115060A

COUPLING NUT

STAINLESS STEEL SS
 NICKEL-BRASS NB

Trunk Gender Changers

Specifications

MECHANICAL

CONNECTOR FACE: THERMO PLASTIC ELASTOMER
 MOLDED BODY: THERMO PLASTIC ELASTOMER
 COUPLING NUT: ZINC DIECAST, BLACK E-COAT – STAINLESS STEEL, NICKEL-PLATED BRASS OPTIONAL

ELECTRICAL

VOLTAGE RATING: 50V
 AMPERAGE: 8A
 CONTACT MATERIAL: PHOSPHOR BRONZE ALLOY
 CONTACT PLATING: GOLD OVER NICKEL

ENVIRONMENTAL

PROTECTION: IP67
 AMBIENT OPERATING TEMP: 4° TO 176° F (-20° TO 80° C)

DIMENSIONS

Female Cordset to Male Receptacle

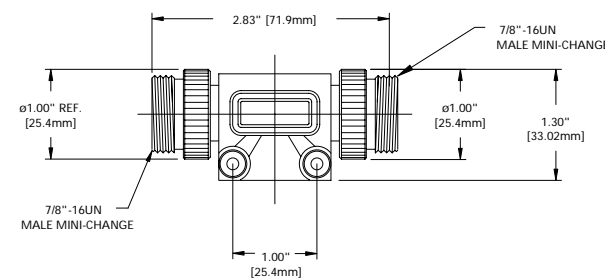

FIG 1

Male Cordset to Female Receptacle

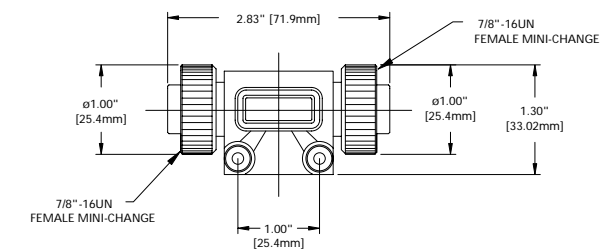

FIG 2

90° Male to Female Connector

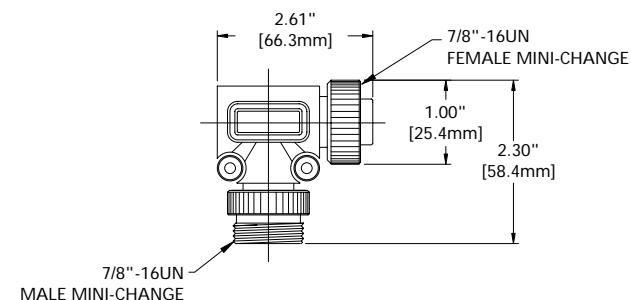

FIG 3

SCHEMATIC

Gender changers

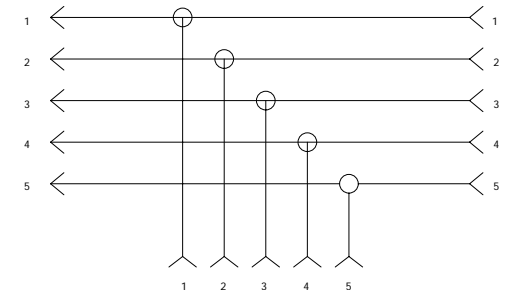

FIG 4